

Space Plans

Sixth Floor

Corporate Layout

9,720 sq ft / 903 sq m



GRESHAM STREET

CITY OF LONDON

Cellular Offices	4
Open-Plan Workstations	88
Total Headcount	92

Meeting Rooms	
4 Seater Meeting Room x3	12
6 Seater Meeting Room x2	12
8 Seater Meeting Room x1	8
14 Seater Meeting Room x1	14
Total Seat Count	46

IPR Per Total Headcount 10 sq m 106 sq ft

IPR – Indicative Planning Ratio

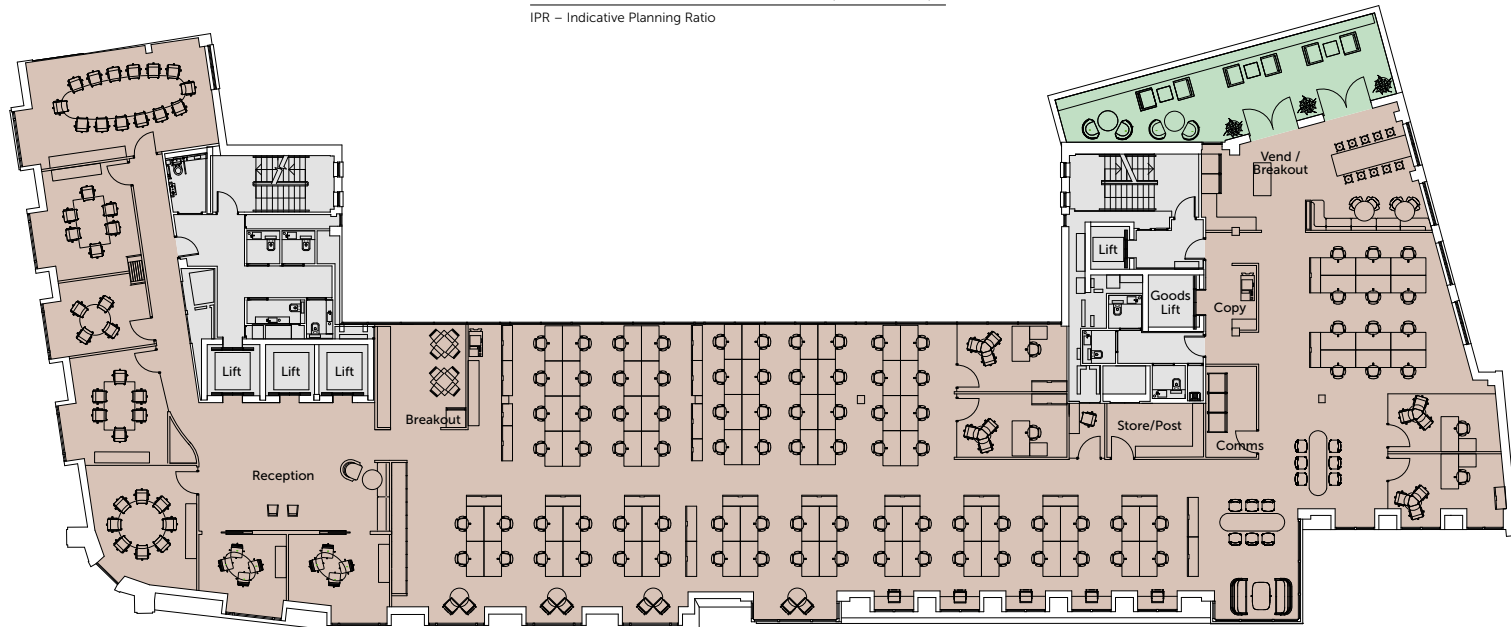

- Core
- Office
- Terrace

