

Space Plans

First Floor

UK/US Legal Hybrid Layout

13,343 sq ft / 1,240 sq m



GRESHAM STREET

CITY OF LONDON

Single Fee Earner Offices x9	9
Double Fee Earner Offices x19	38
Fee Earner Workstations	47
Administrative Assistants (1 AA:4 FE)	11
Business Support Workstations	2
Receptionists	2
Total Workstations	62

Client Suite

6 Seater Meeting Room x1	6
8 Seater Meeting Room x4	32
18 Seater Meeting Room x1	18
Total Seat Count	56

IPR Per FE Workstations 26 sq m 284 sq ft

IPR Per Total Workstations 20 sq m 215 sq ft

IPR – Indicative Planning Ratio

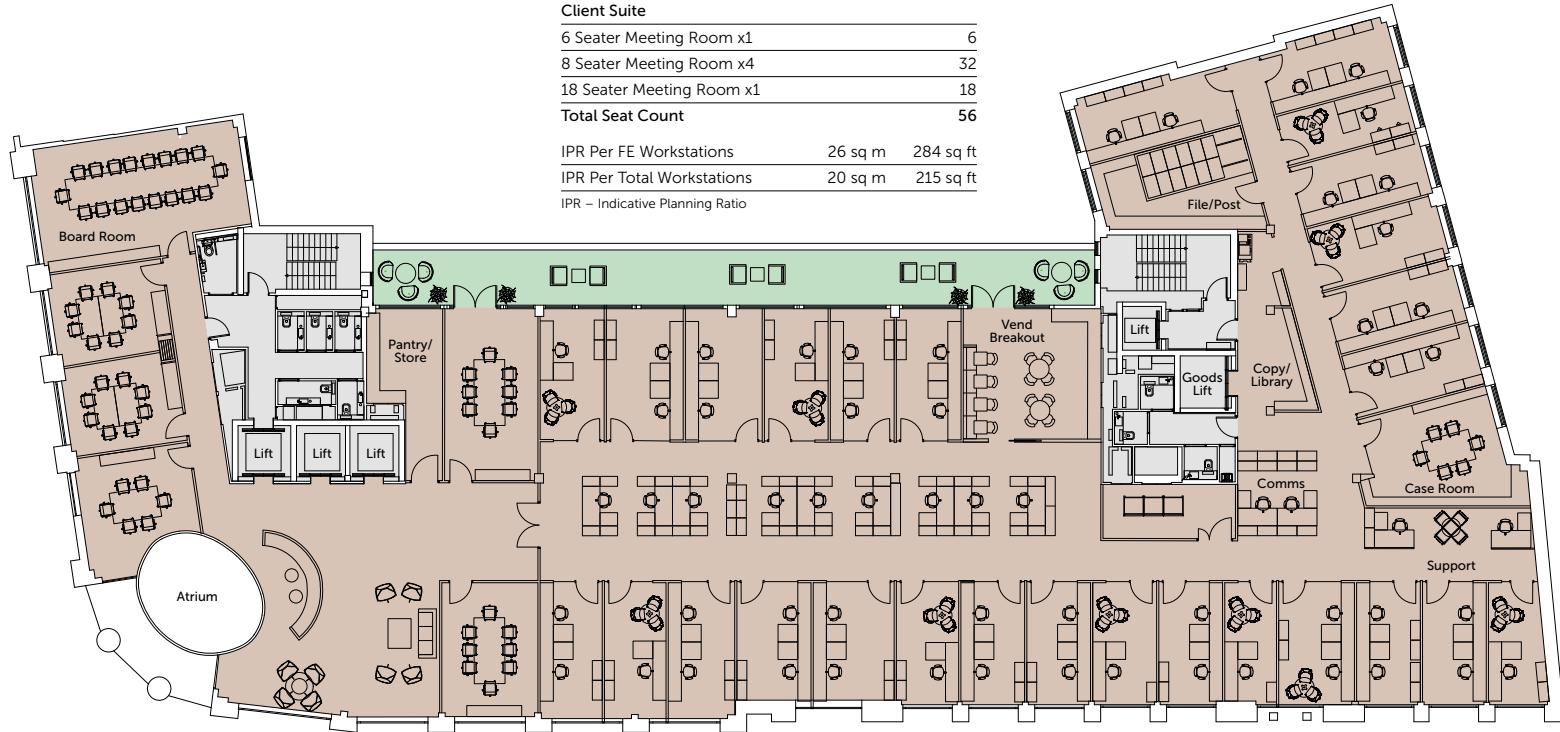

- Core
- Office
- Terrace

